

I-Class™ *Mark II*

Wired/Wireless LAN Option ■ ■ ■



right by our customers. ■ ■ ■



datamax•o'neil

Overview

This document describes the installation and use of the Wired/Wireless LAN option for the I-Class Mark II printer. Follow the steps to begin installing the option.



For safety and to avoid equipment damage, turn OFF the power switch and unplug the AC power cord from the printer before starting this installation.

Contents

This kit contains the following items:

- ① LAN Card Assembly
- ② Wireless Module (*wireless kits only*)
- ③ Antenna Connector (*wireless kits only*)
- ④ Antenna (*wireless kits only*)
- ⑤ Standoff, 6mm Hex (2)
- ⑥ Locking Nut, 5.5mm (2)
- ⑦ Screw, 2.5mm Socketed Hex

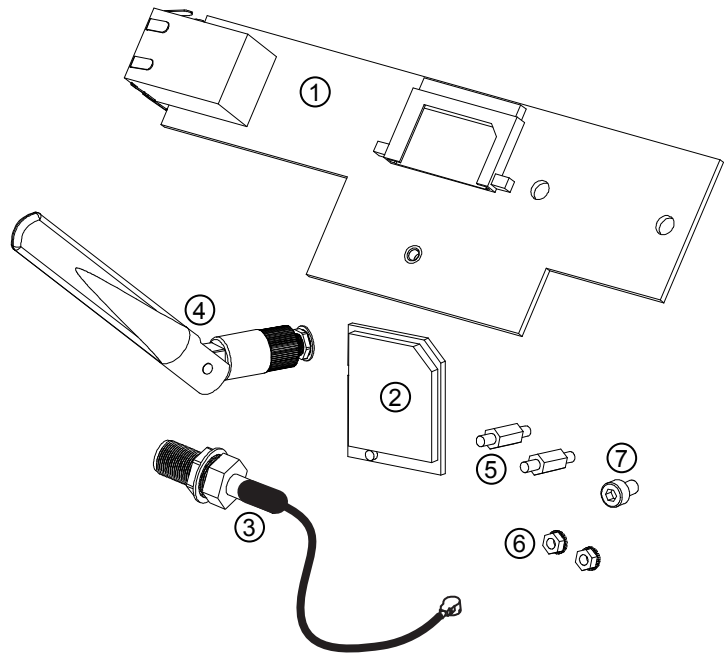

Tools Required

To install this option, you will need:

- Philips screwdriver
- 5mm Hex Driver
- 5.5mm Hex Driver
- 6mm Hex Driver
- 2.5mm Hex Key
- 5/16" or 8mm Wrench

Installing the Option

Install the LAN Card as described below:

- A)** Turn off and disconnect the power cord from the printer. Remove the three Screws from the left side cover of the printer.
- B)** Open the printer's cover, loosen (*do not remove*) the two Screws on the inside of the printer and lift the Cover Assembly up and off the printer.

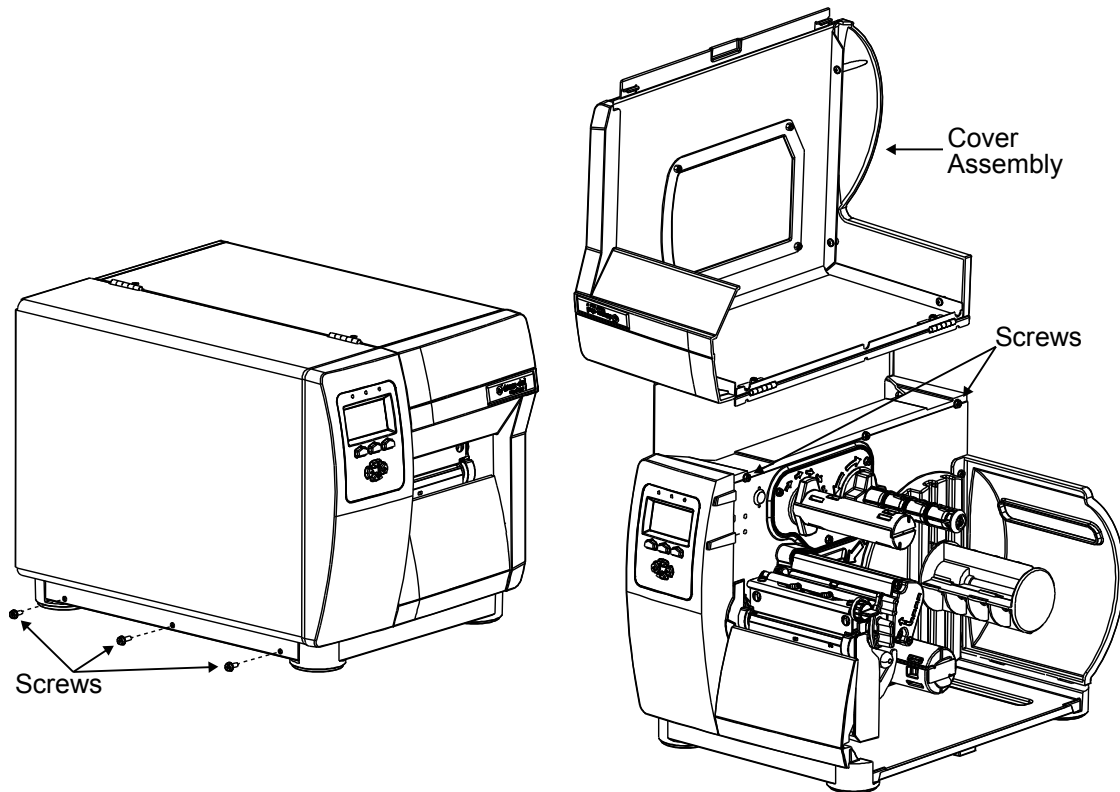

- C)** Remove the 5mm Screw and Cover Plate from the rear of the printer.

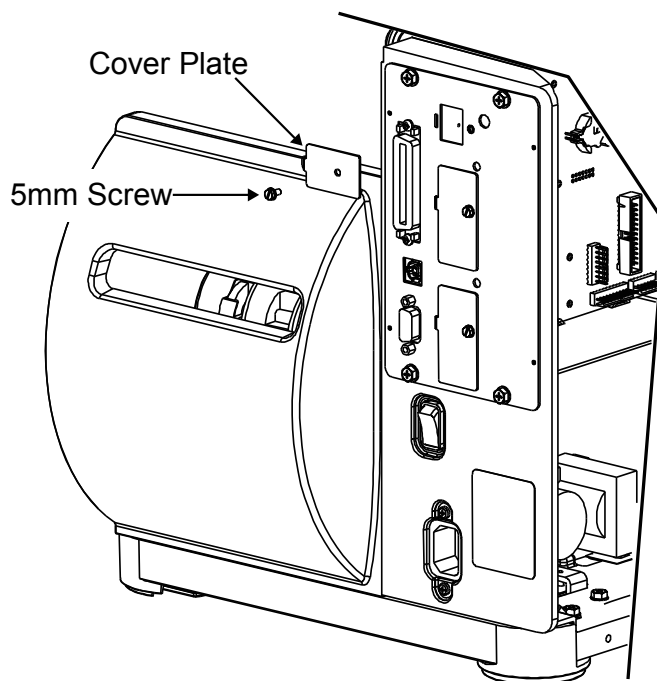

- D)** Install the two 6mm Standoffs into the main board in the locations shown.

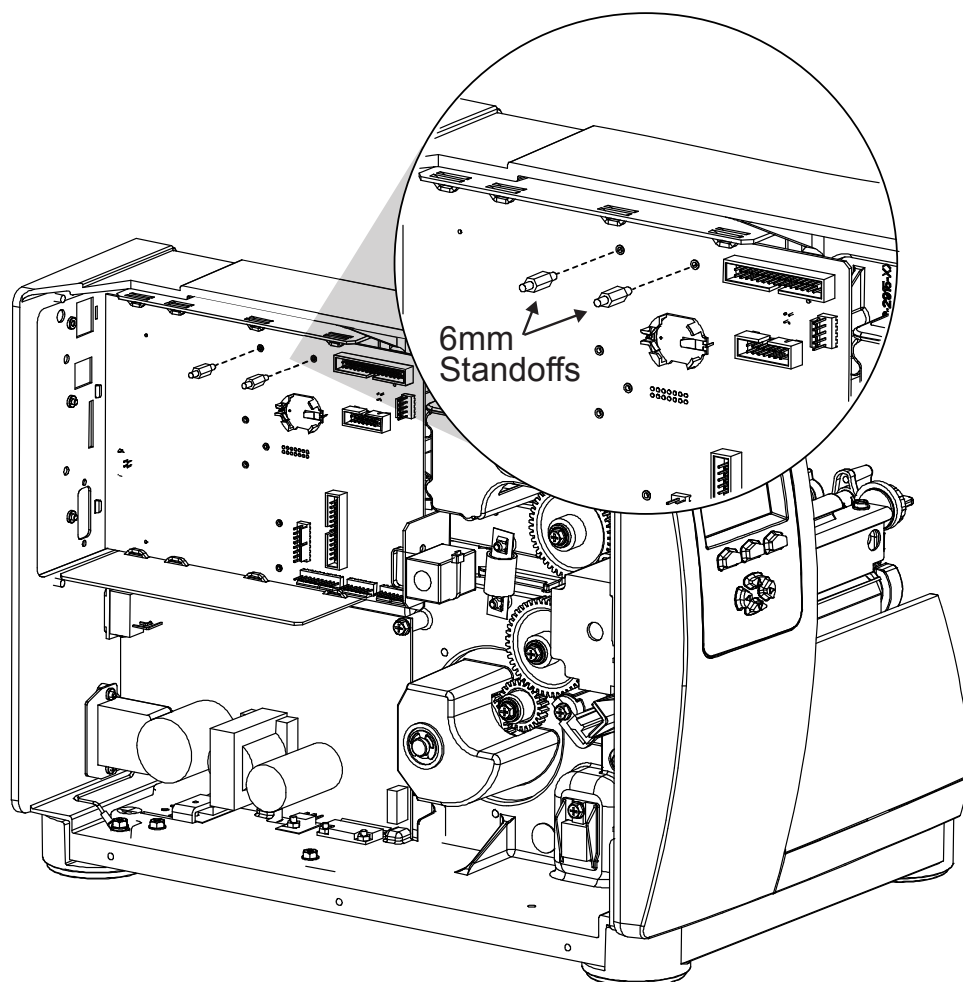

- E)** Install the LAN Card into the printer. First insert the “Port” end into the cut-out in the rear of the printer. Then pivot the LAN Card onto the two Standoffs.
- F)** Install the two 5.5mm Nuts.

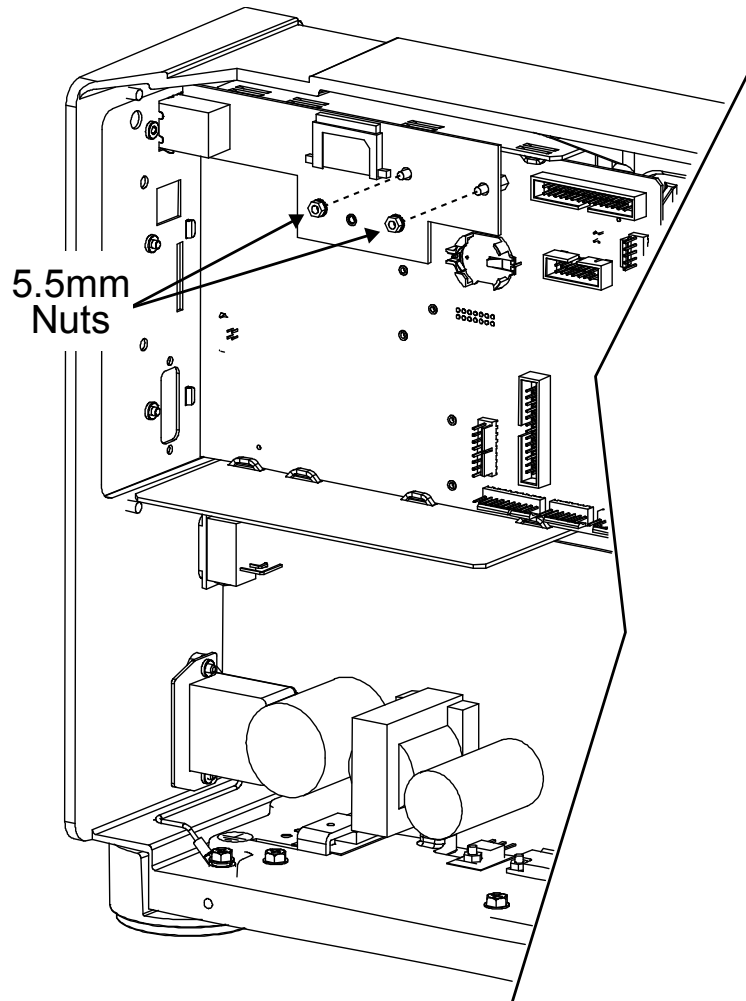

- G)** LAN Card installation is complete. If your kit contains the Wireless Option, Proceed to “Installing Wireless Module and Antenna” on the next page. Otherwise re-install the printer’s cover and refer to the Operator’s Manual for connection and configuration information.

Installing Wireless Module and Antenna

Install the Wireless Module and Antenna as described below::

- A)** Orient the Wireless Module as shown and insert it into the Module Connector, be sure the Wireless Module is fully seated.
- B)** Install the 2.5mm Socketed Hex Screw in the hole directly below the Wireless Module.

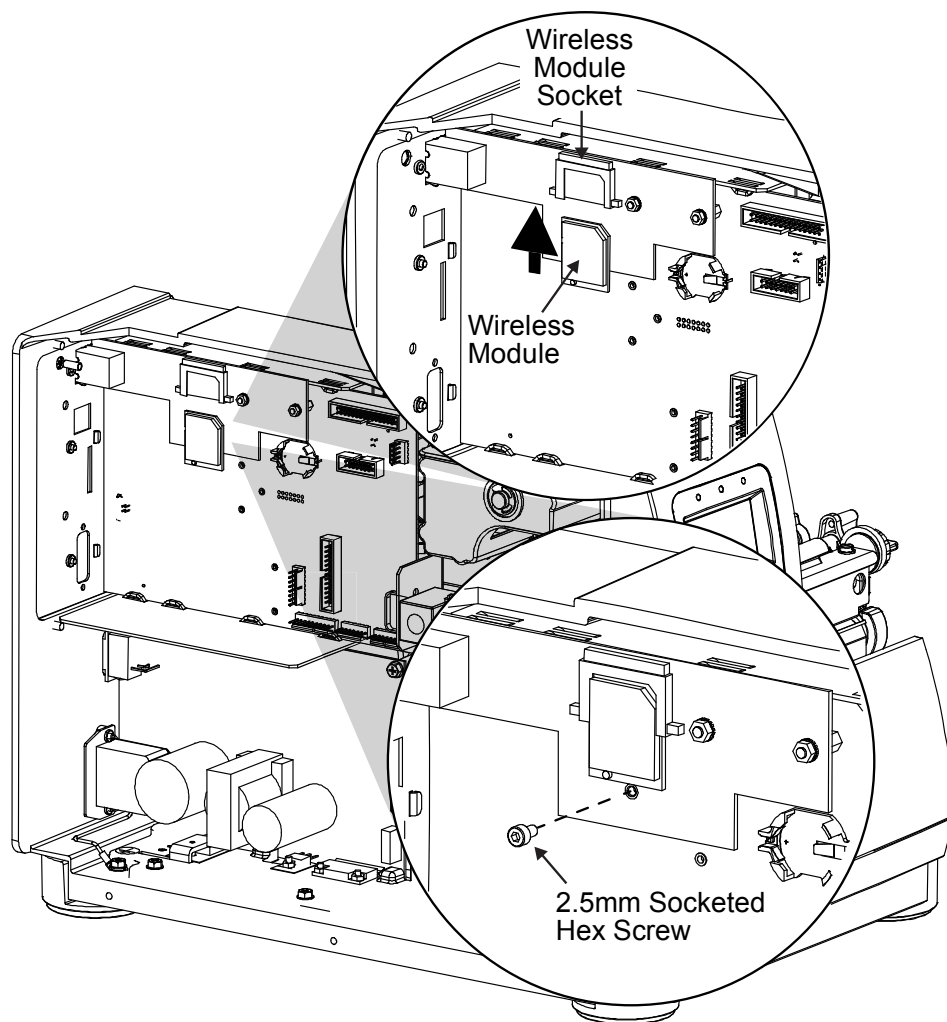

- C)** Remove the Nut and Washer from the Antenna Connector.

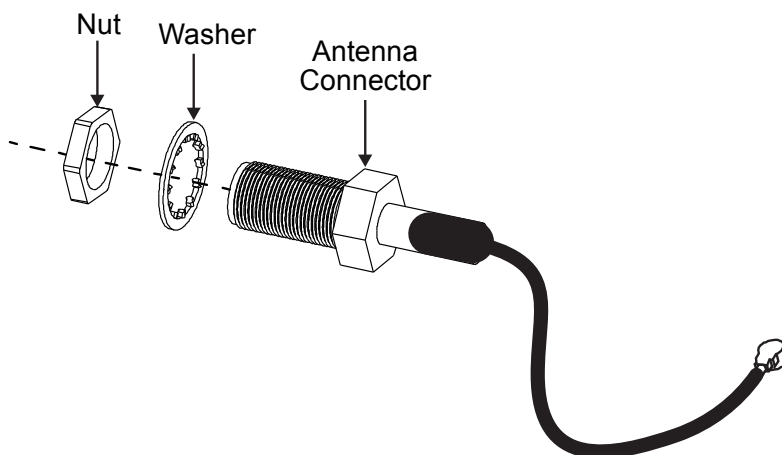

D) Insert the Antenna Connector through the hole in the printer's Back Panel.

E) Re-install the Nut and Washer onto the Antenna Connector and tighten using a 5/16" or 8mm Wrench.

F) Connect the Antenna Connector Wire to the connector on the Wireless Module.

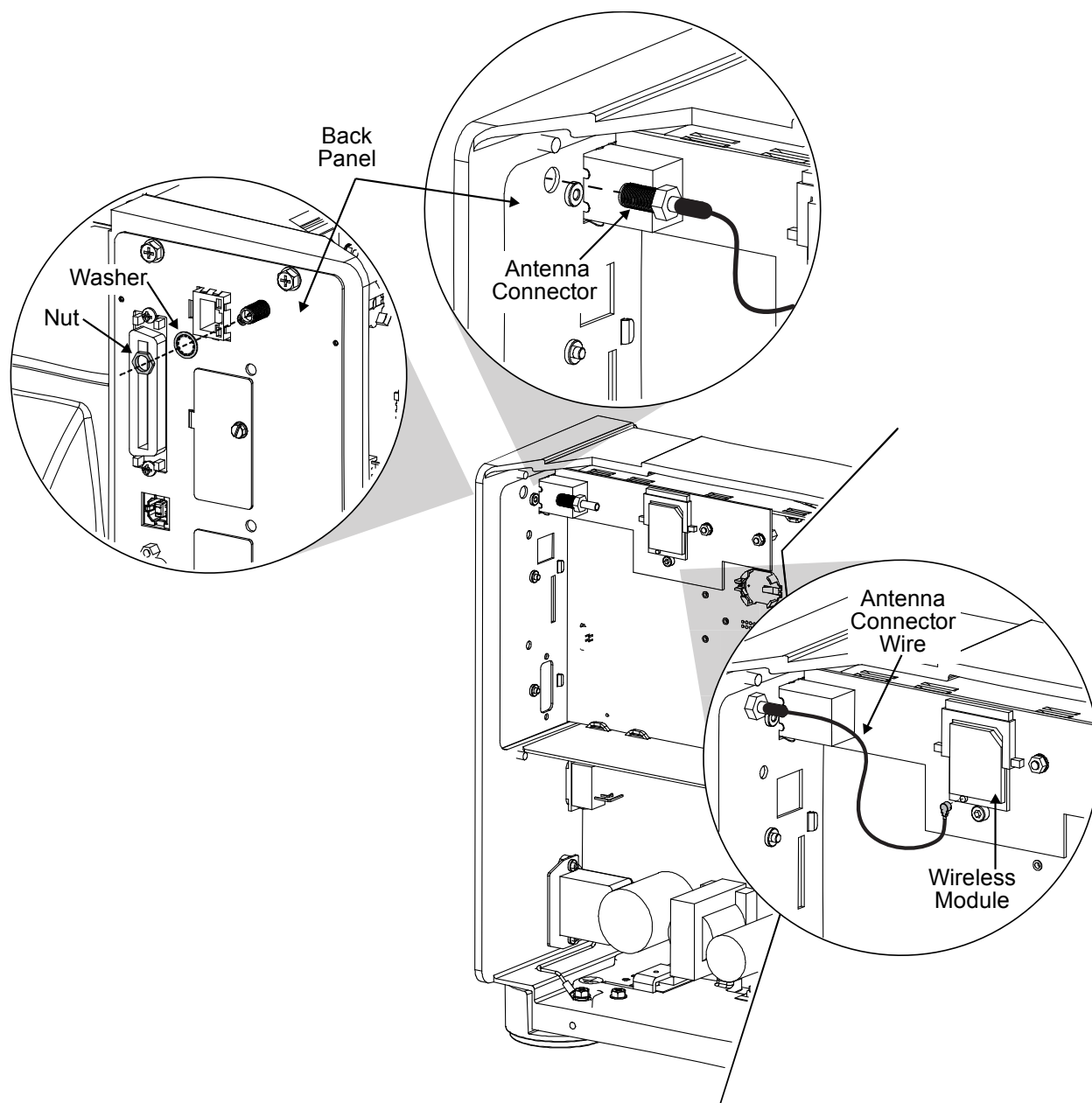

- G)** Screw the Antenna onto the Antenna Connector and pivot the Antenna up for best reception.

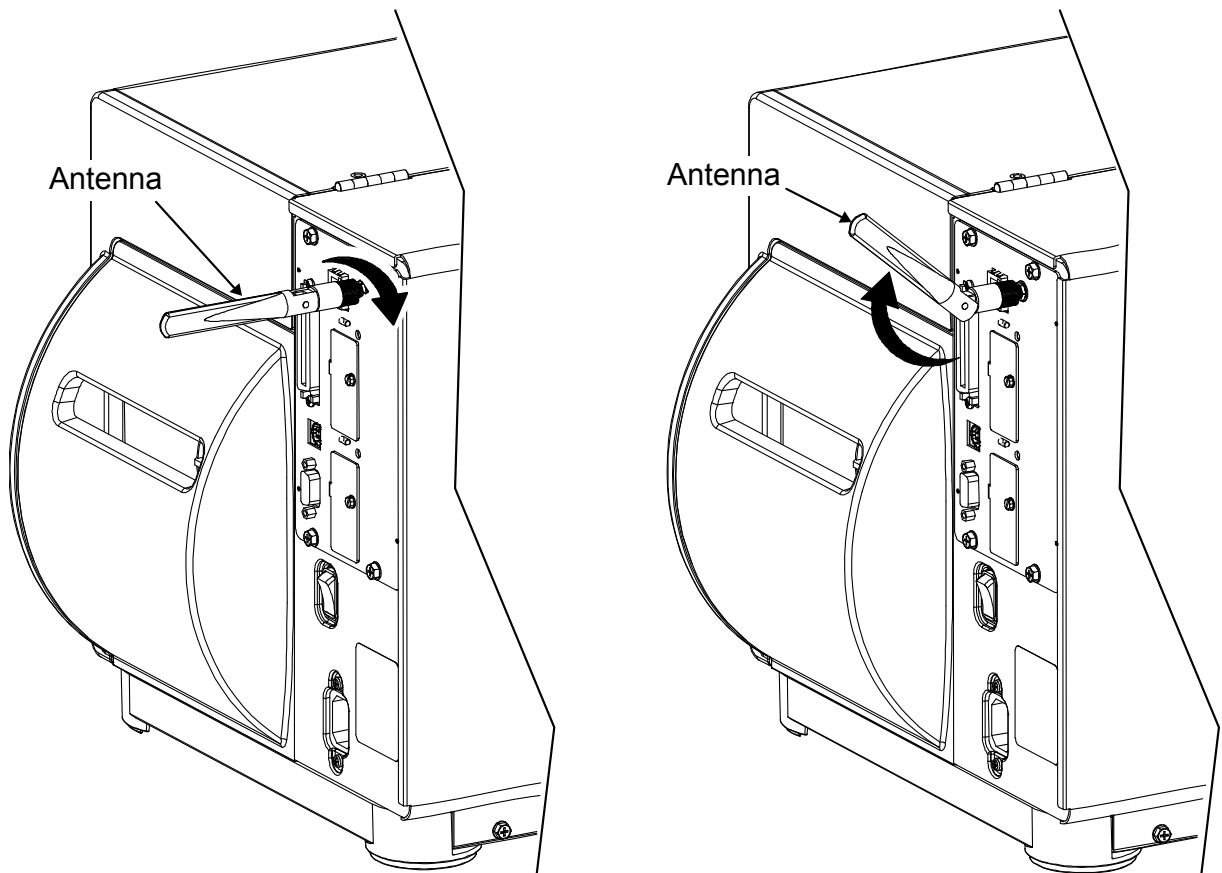

- H)** Wireless installation is complete. Re-install the printer's cover and refer to the Operator's Manual for connection and configuration information.

